

# MT1 Charging Station (optional) introduction

## 1. Safety Instructions

### 1.1 Instruction for Use

- Charging station users should receive professional training from technical support personnel.
- Deployment of charging station may involve lightweight construction of circuits, so professionals are required to implement.
- The charging station should be placed in an indoor scene with normal temperature. It is forbidden to place the charging station in a high temperature area ( $> 40^{\circ}\text{C}/104^{\circ}\text{F}$ ) for use.
- If the charging station is damaged, or the charging current is abnormal, please stop using the charging station.
- Be sure to use the original power cord, and it is strictly forbidden to use non-original power cords to supply power to the charging station.
- Carefully protect the power cord to avoid pulling and twisting.
- It is strictly forbidden for the charging station to collide with foreign objects, causing damage to the charging station.
- Do not use the charging station near flammable and explosive objects.
- If the charging station emits smoke or burnt smell, it means that the charging station is abnormal, please disconnect the power supply of the charging station immediately and contact Pudu staff.
- Do not move the charging station arbitrarily when in use, and use the charging station at the designated location.
- It is strictly forbidden to store or work in areas exposed to direct sunlight.
- If there is an abnormal red light on the charging station, please separate the robot from the charging station. Wait for the charging station light to turn blue before it can be used again.
- If the red light does not go off for a long time, please contact technical support personnel.
- This appliance can be used by children aged from 8 years and above and persons with reduced physical, sensory or mental capabilities or lack of experience and knowledge if they have been given supervision or instruction concerning use of the appliance in a safe way and understand the hazards involved. Children shall not play with the appliance. Cleaning and user maintenance shall not be made by children without supervision.
- Children should be supervised to ensure that they do not play with the appliance.
- Warning against recharging non-rechargeable batteries.
- Before using battery charger, read all instructions and cautionary markings on battery charger, battery, and product using battery.
- For indoor use, or do not expose to rain.
- Use only with battery charger for model AP-PF600CH02920150B.
- Use only with commercial cleaning robot for model MTBC01.

### 1.2 Environment Notice

- Working environment temperature:  $0^{\circ}\text{C}-40^{\circ}\text{C}$  ( $32^{\circ}\text{F}-104^{\circ}\text{F}$ ), relative humidity: 0% ~ 90%RH.
- Storage ambient temperature:  $-20^{\circ}\text{C}-70^{\circ}\text{C}$  ( $-4^{\circ}\text{F}-158^{\circ}\text{F}$ ), relative humidity: 0% ~ 90%RH, storage for 1 year.
- Working environment requirements:
  1. The charging station needs to be placed on a flat ground for use, with its back against a flat wall, and fixed to the wall or the ground through lateral connection components.

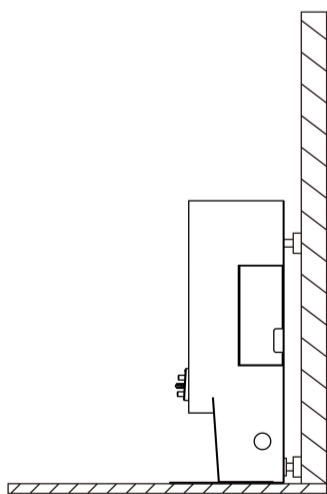

2. No reflective or transparent parts such as mirrors or glass are allowed near the working charging pile. If unavoidable, some adjustments to the working environment are necessary.
3. No flammables are allowed near the charging pile.
4. During normal operation, keep open and unobstructed within 2 m (6.56 ft) in front and 1.5 m (4.92 ft) in the left and right directions.

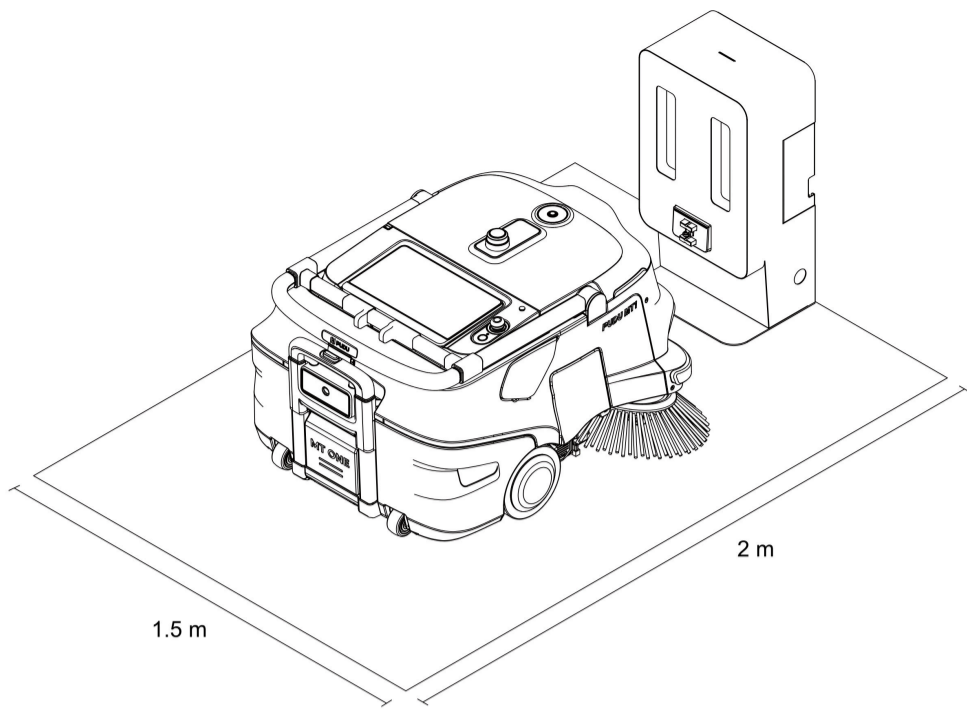

## 2. Product Introduction

### 2.1 Packing List

Machine x 1, User Manual x 1, Certificate of Compliance x 1, Warning tape x 1

### 2.2 Appearance Introduction

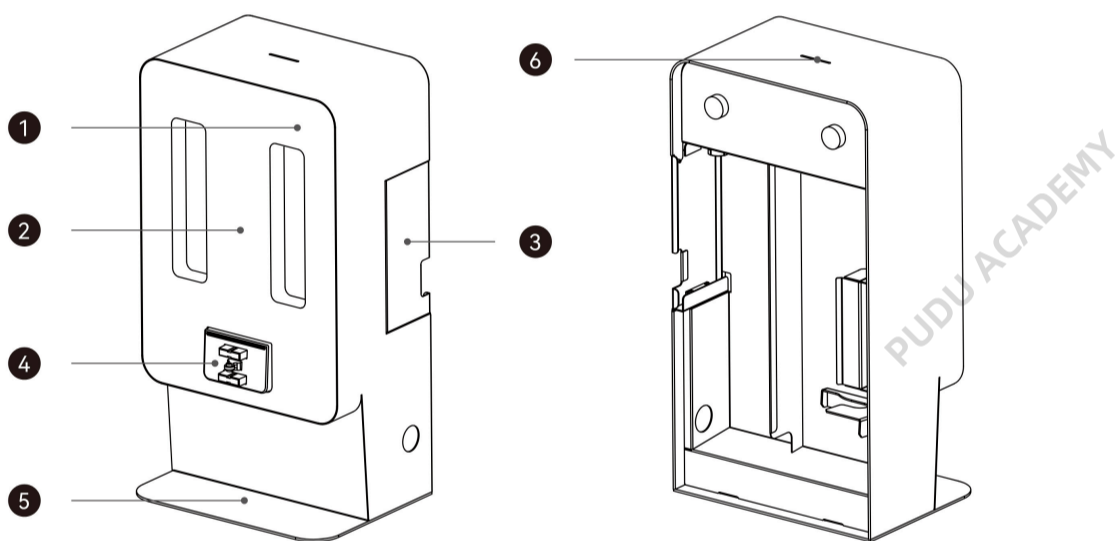

No.	Description	No.	Description
1	Front shell	4	Electrode holder
2	QR code board	5	Bottom plate
3	Power adapter compartment side cover	6	Indicator light

### 2.3 Performance Parameters

Feature	Description
Product name	MT1 charging station
Product function	Support automatic charging for robot
Dimensions (LxWxH)	32*24.15*60 cm (12.60*9.51*23.62 inches)
Input voltage	AC 90-264 V, 50-60 Hz
Output voltage	Max.: 29.2 V, 20 A
Working temperature	0°C-40°C (32°F-104°F)
Storage temperature	-20°C-70°C (-4°F-158°F)
Working humidity	0-90%RH
Storage humidity	0-90%RH
Communication method	Bluetooth
Transmit frequency	2400-2483.5 MHz

Transmit power	≤ 10 dbm
Installation requirements	Back against the wall fixed
External dependencies	Power supply

## 3. Using the Product

### 3.1 Instructions for Use

- Deploy charging station at specific locations according to the "1.2 Environmental Notice".
- Install the battery charger of the MT1 robot inside the charging station (as shown in the figure below), and please use the power cord of the MT1 battery charger for the external power connection of the charging station.

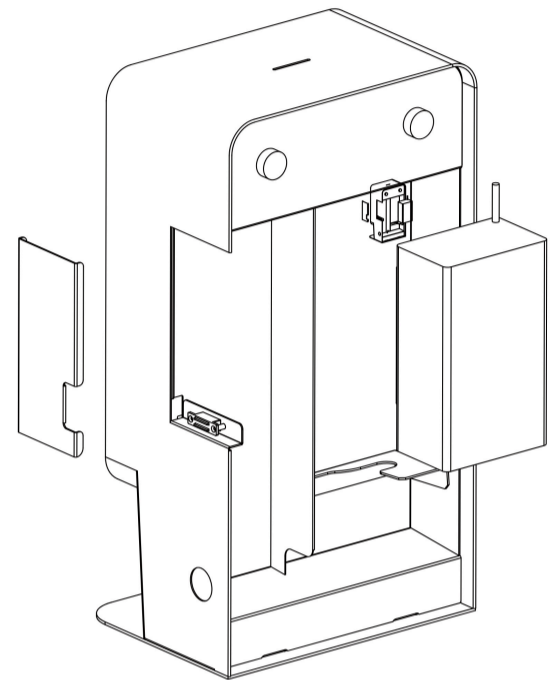

\* When installing, pay attention to the heat dissipation hole of the power adapter facing down.

- You can use identification stickers to mark the positions on both sides of the charging station (as shown in the figure below).

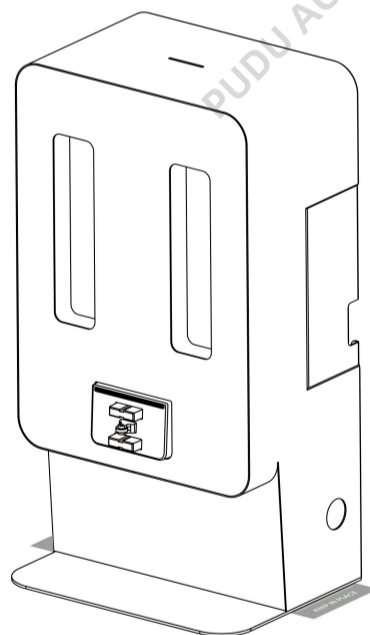
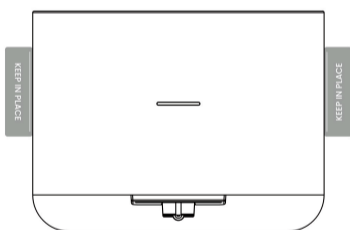

## 4. Indicator Light Description

Status	Description
Steady Blue	Normal standby (not connected to the robot)
Flashing Green	Connecting with the robot
Steady Green	Connection succeeded
Red	Fault occurred

## 5. Maintenance

- If the charging station is dirty or dusty, use a soft, clean cloth to wipe it clean.
- In case of cracks, deformation, or inability to charge, etc., please disconnect the power and contact the after-sales service promptly.

## 6. After-sales Service

Shenzhen Pudu Technology Co., Ltd provides free warranty service within the effective warranty period (the warranty period may vary for different components). The fees incurred by the after-sales service will be covered by Pudu. Beyond the warranty period or in any circumstances not covered by the free warranty, a certain fee will be charged according to the normal price. Please call the after-sales hotline for detailed after-sales service policy and repair services.

Email: [techservice@pudutech.com](mailto:techservice@pudutech.com)

PUDU ACADEMY